

Technical Data

Rating at 100% duty cycle (10 min. cycle)	
- Mixed gas:	450 A
- bei CO ₂ :	500 A
Cooling method	Water cooling
Wire diameter	1.0 - 1.6 mm
Gas flow	16 l/min
Technical specification	according to IEC 60974-7
Weight with 1.5 m cable	1.60 kg
Connection	Euro-Central connector Other connectors are available upon request.

Torch rating will be reduced when using pulsed-arc power sources.

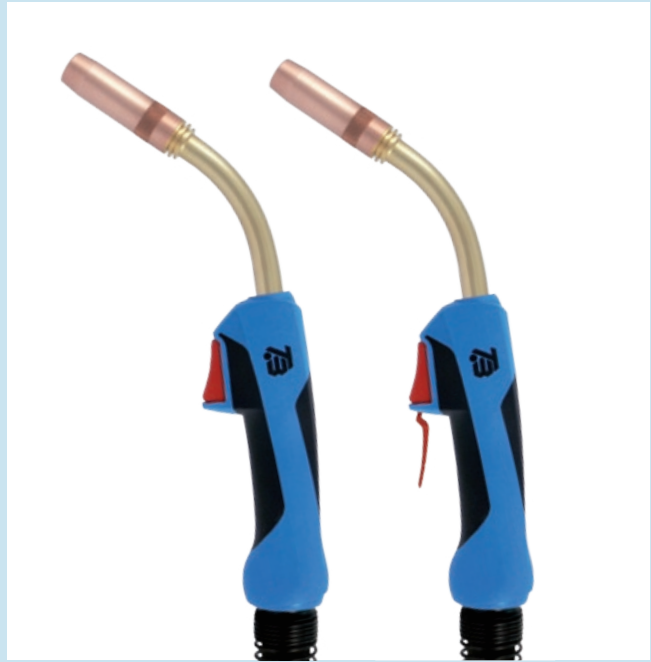

Contact tips

	Pos.	Part No.
M8	▶ 10 ECu, M8 x 30	340P__1262*
	CuCrZr, M8x30	340P__3262*
	Alu, ECu, M8x30	341P__1262*
M6	11 ECu, M6x28	340P__1069*
	CuCrZr, M6x28	340P__3069*
	Alu, ECu, M6x28	341P__1069*

Tip holders

	Pos.	Part No.
20	for contact tip M8	342P008033
	für M8, CuCrZr for better cooling	342P008171
	for contact tip M8, long ver.	342P008133
21	for contact tip M6	342P006033
	for contact tip M6, long ver.	342P006133

▶ = Standard equipment

* At the blank, please insert suitable information for torch length or wire diameter, e.g. 3 for 3 m or 08 for 0.8 mm.

Ordering information for torches

Supplied equipped for steel wire Ø 1.0 mm

TBi 7W Expert	with Euro central connector	3 m	174P422030
		4 m	174P422040
		5 m	174P422050
TBi 7W Expert	with Euro central connector and long trigger	3 m	174P4L2030
		4 m	174P4L2040
		5 m	174P4L2050

Spare parts

Pos.	Description	Part No.
50	Torch neck TBi 7W-S (short), 50°	174P101005
51	Insulating washer	130P002004
60	Handle Expert cpl., water cooled	380P230003
61	Handle Expert cpl., water cooled, long trigger	380P230004
62	Screw for Expert handle	100P541101
63	Trigger, red, 2 poles	385P021016
64	Trigger long, red, 2 poles	385P021018

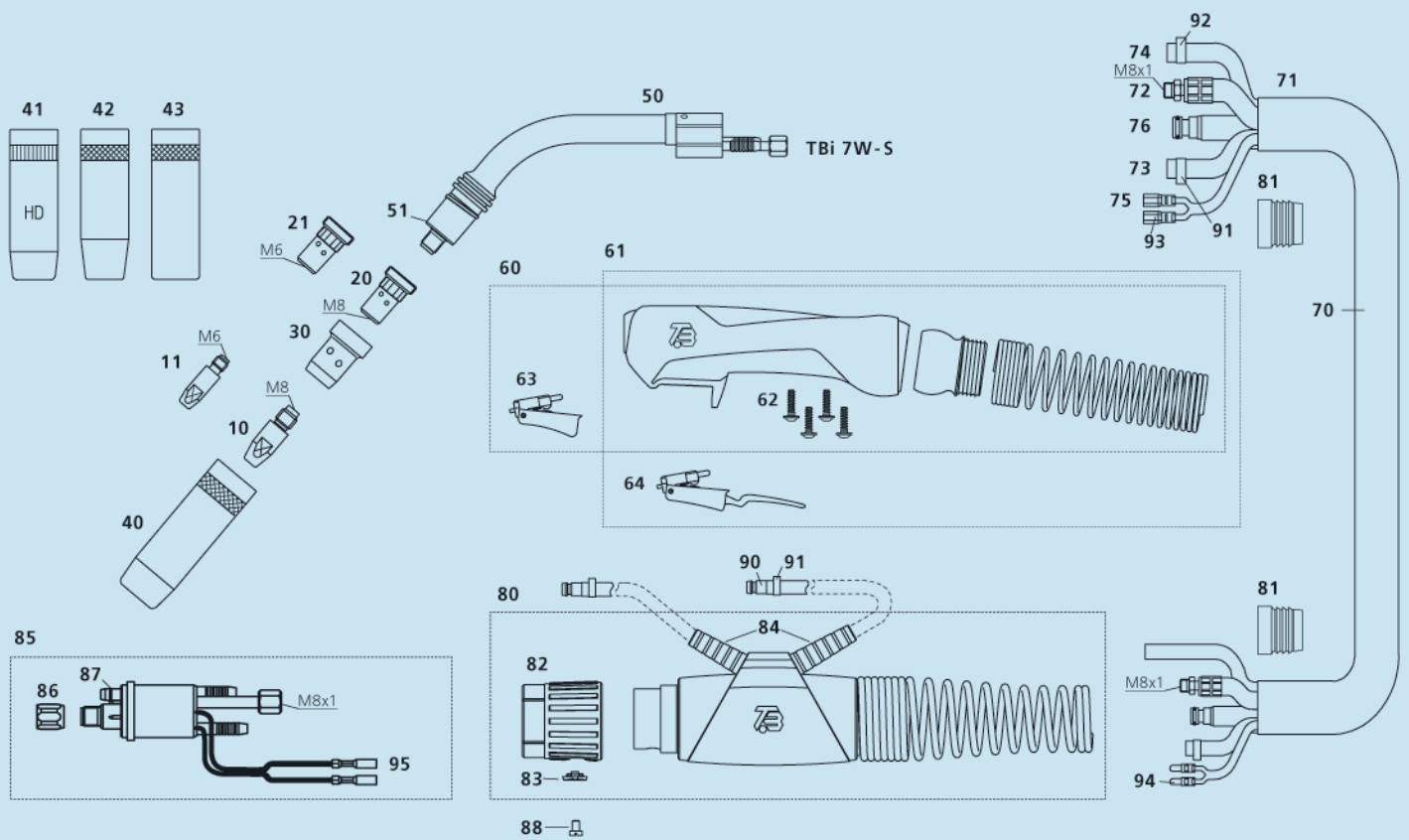

Gas diffuser



Pos.	Description	Part No.
30	thermoset, black, very robust	130P002026
31	ceramic, white, extremely heat resistant	130P002019

Gas nozzle



Pos.	Description	Part No.
40	conical, NW 16 mm L= 75.5 mm	345P022171
41	conical, NW 16 mm Heavy Duty L= 75.5 mm	345P022271
42	conical, NW 14 mm L= 75.5 mm	345P023171
43	cylindrical, NW 19 mm L= 75.5 mm	345P021171

Pos.	Description	Part No.	Pos.	Description	Part No.
70	Cable assembly Expert ,Top 2000', 2-C	174P4040_0*	85	Central adaptor ESW cpl., moveable pins ,Top 2000'	701P101006
71	Fabric outer cover 25x1.5 mm, for Expert	307P2528_E*	86	Sleeve nut M10x1	701P002005
72	Water-power cable ,Top 2000', blue, 2-C	316P1622_0*	87	O-Ring 4.0x1.0 mm (gas nipple)	365P100040
72	Water-power cable ,Top 2000', black, HD (option)	314P1622_0*	88	Screw M4x6	100P008401
73	Water hose 2-C, black, 5x1.5 mm	303P070000	90	Quick connector	701P002064
74	PVC-Gas hose, black, 4.5x1.5 mm	302P010000	91	Hose clamp Ø 9.5 with ring	373P100095
75	Control cable x.30 m cpl.	301P2304_0*	92	Hose clamp Ø 8.7	371P000087
76	Wire conduit ,Top 2000', yellow	356P0C0C_0*	93	Cable lug, flat	375P000023
80	Cable support Expert cpl., water cooled	700P001066	94	Insulated connector, male, round	375P000004
81	Clamping ring for outer cover	600P102201	95	Insulated connector, female, round	375P000003
82	Adaptor nut Expert	700P001010			
83	Cap for adaptor nut Expert	700P002059			
84	Grommet for Expert	700P002058			