

Technical Data

Rating at 60% duty cycle
(10 min. cycle)

- Mixed gas: 310 A
- bei CO₂: 340 A

Cooling method Gas cooling

Wire diameter 1.0 - 1.6 mm

Gas flow 16 l/min

Technical specification according to IEC 60974-7

Weight with 1.5 m cable 2.30 kg

Connection Euro-Central connector
Other connectors are available upon request.

Torch rating will be reduced when using pulsed-arc power sources.

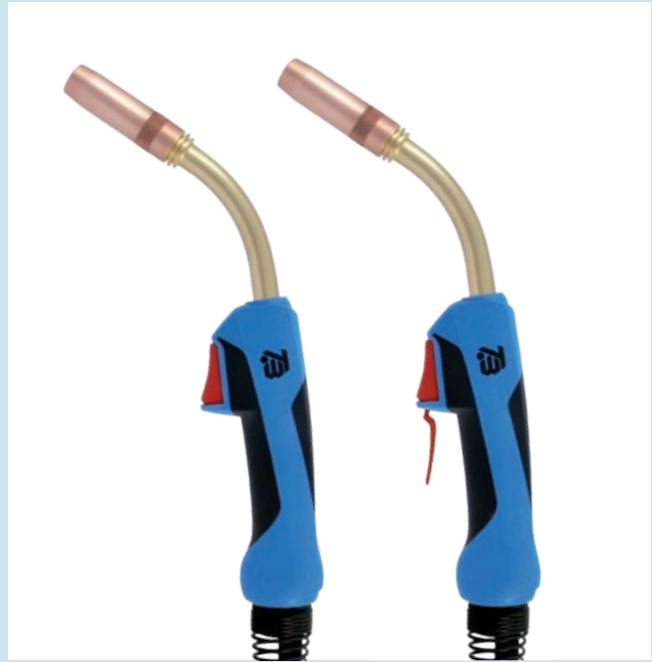

Contact tips

| | Pos. | Part No. |
|-----------|--------------------------|--------------------|
| M8 | ▶ 10 ECu, M8 x 30 | 340P__1262* |
| | CuCrZr, M8x30 | 340P__3262* |
| | Alu, ECu, M8x30 | 341P__1262* |
| M6 | 11 ECu, M6x28 | 340P__1069* |
| | CuCrZr, M6x28 | 340P__3069* |
| | Alu, ECu, M6x28 | 341P__1069* |

Tip holders

| | Pos. | Part No. |
|-----------|-----------------------------------|-------------------|
| 20 | ▶ for contact tip M8 | 342P008033 |
| | für M8, CuCrZr for better cooling | 342P008171 |
| | for contact tip M8, long ver. | 342P008133 |
| 21 | for contact tip M6 | 342P006033 |
| | for contact tip M6, long ver. | 342P006133 |

▶ = Standard equipment

* At the blank, please insert suitable information for torch length or wire diameter, e.g. 3 for 3 m or 08 for 0.8 mm.

Ordering information for torches

Supplied equipped for steel wire Ø 1.0 mm

| Torch Model | Connector | Length | Part No. |
|----------------------|--|--------|------------|
| TBi 7G Expert | with Euro central connector | 3 m | 166P322030 |
| | | 4 m | 166P322040 |
| | | 5 m | 166P322050 |
| TBi 7G Expert | with Euro central connector and long trigger | 3 m | 166P3L2030 |
| | | 4 m | 166P3L2040 |
| | | 5 m | 166P3L2050 |

Spare parts

| Pos. | Description | Part No. |
|------|--|------------|
| 50 | Torch neck TBi 7G-S (short), 50° | 166P101140 |
| 51 | Insulating washer | 130P002004 |
| 52 | PVC body | 600P002018 |
| 60 | Handle Expert cpl., gas cooled | 380P230001 |
| 61 | Handle Expert cpl., gas cooled, long trigger | 380P230002 |
| 62 | Screw for Expert handle | 100P541101 |
| 63 | Trigger, red, 2 poles | 385P021016 |
| 64 | Trigger, red, 2 poles, long | 385P021018 |

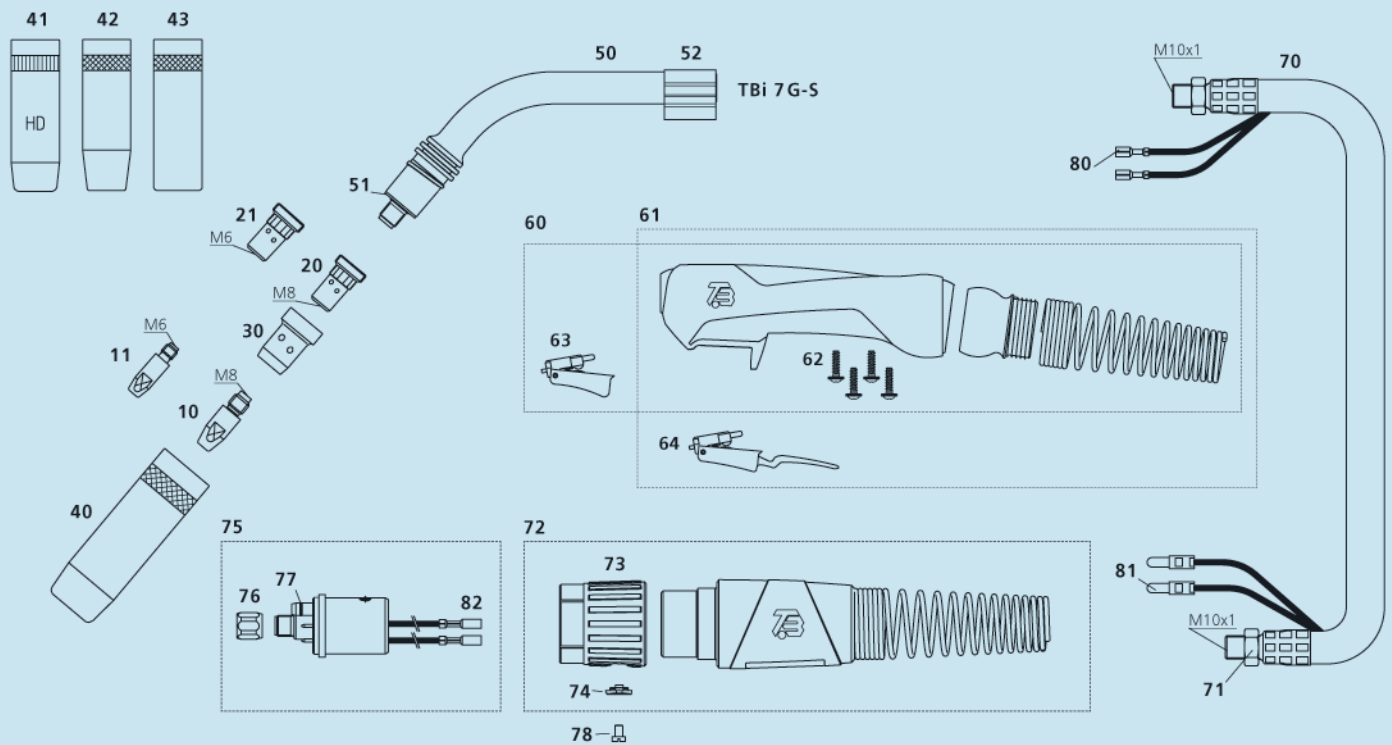

Gas diffuser



| Pos. | Description | Part No. |
|------|--|------------|
| 30 | thermoset, black, very robust | 130P002026 |
| 31 | ceramic, white, extremely heat resistant | 130P002019 |

Gas nozzle



| Pos. | Description | Part No. |
|------|---|------------|
| 40 | conical, NW 16 mm L= 75.5 mm | 345P022171 |
| 41 | conical, NW 16 mm Heavy Duty L= 75.5 mm | 345P022271 |
| 42 | conical, NW 14 mm L= 75.5 mm | 345P023171 |
| 43 | cylindrical, NW 19 mm L= 75.5 mm | 345P021171 |

| Pos. | Description | Part No. |
|------|--|-------------|
| 70 | TBi-Flex coaxial cable 50 sqmm | 360P5011_0* |
| 71 | Hex nut M10x1 | 101P002005 |
| 72 | Cable support Expert cpl., gas cooled | 700P001064 |
| 73 | Adaptor nut Expert | 700P001010 |
| 74 | Cap for adaptor nut Expert | 700P002059 |
| 75 | Central adaptor ESG cpl., 2 poles, moveable pins | 701P001048 |
| 76 | Sleeve nut M10x1 | 701P002005 |
| 77 | O-Ring 4.0x1.0 mm (gas nipple) | 365P100040 |
| 78 | Screw M4x6 | 100P008401 |

| Pos. | Description | Part No. |
|------|------------------------------------|------------|
| 80 | Cable lug, flat | 375P000023 |
| 81 | Insulated connector, male, round | 375P000004 |
| 82 | Insulated connector, female, round | 375P000003 |