



Top 2000 TBi 7W E3

Water cooled

Same consumables as TBi 7G / TBi 7W

Slip-on fume shroud

Technical data

MIG/MAG semi-automatic fume extraction welding torch TBi 7W E3

Rating at 100% duty cycle
(10 min. cycle)

- Mixed gas: 400 A
- CO₂: 450 A

Cooling method water cooling

Wire diameter 1.0 - 1.6 mm

Gas flow 15 l/min

Technical specification according to IEC 60974-7

Weight with 1.5m cable 1.70 kg

Connection Euro-Central connector
other connectors are available
upon request.

Torch rating will be reduced when using pulsed-arc power sources.
Custom lengths of the cable assembly are available upon request.

Ordering Information

TBi 7W E3 ESW, 50° bent 274P4E25_0*

* At the blank, please insert 3, 4 or 5 for a torch length of 3, 4 or 5m.

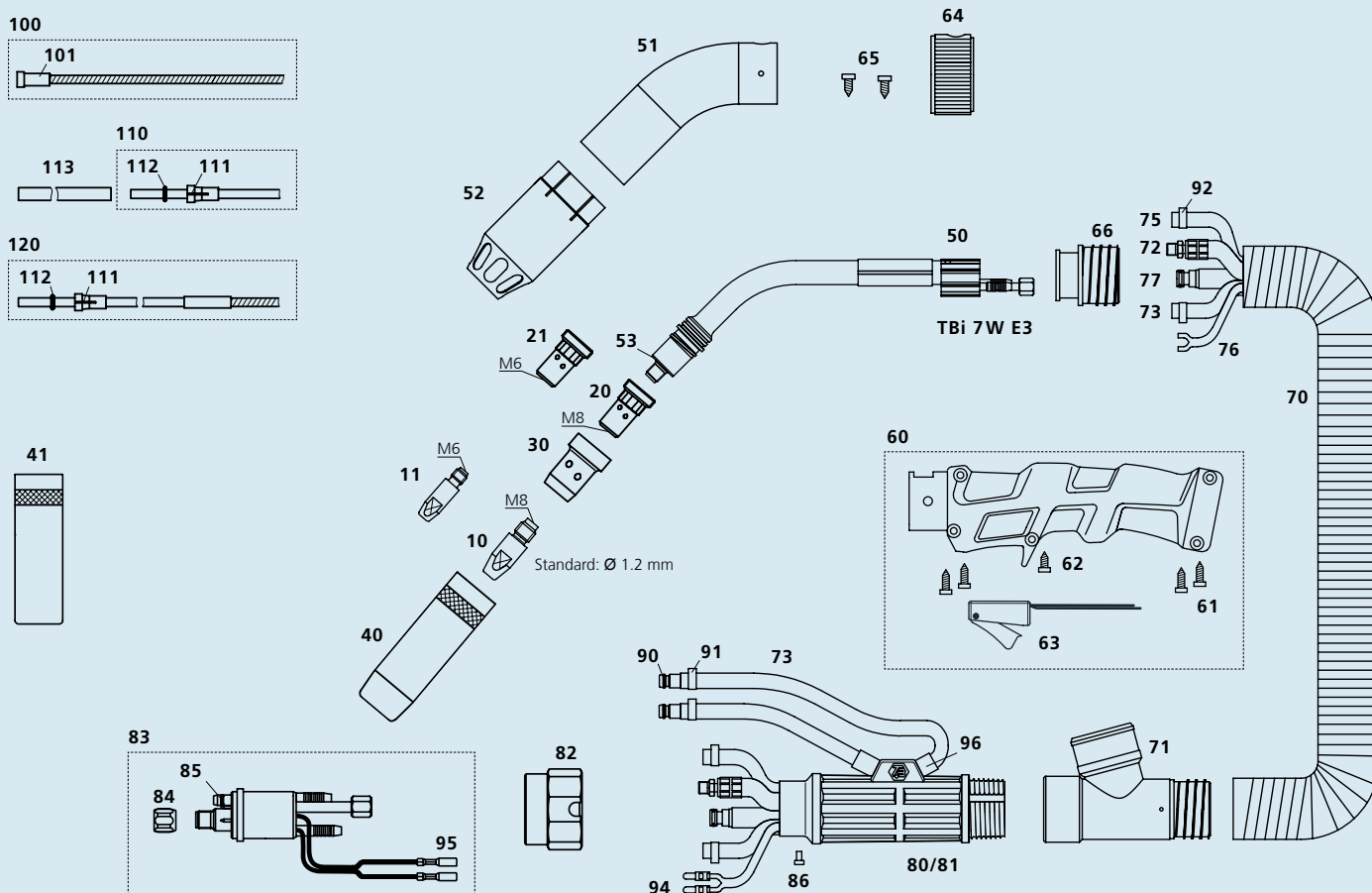

Pos. Description

Part. No.

Pos. Description

Part. No.

Contact tips

► 10	Contact tip M8x30, Ecu	340P_1262*
10	Contact tip M8x30, CuCrZr	340P_3262*
10	Contact tip M8x30 Alu, Ecu	341P_1262*
11	Contact tip M6x28, Ecu	340P_1069*
11	Contact tip M6x28 Alu, Ecu	341P_1069*

Tip holders

► 20	Tip holder M8 / L=25 mm	342P008033
20	Tip holder M8 / L=25 mm, CuCrZr	342P008171
20	Tip holder M8 / L=29 mm	342P008133
21	Tip holder M6 / L=25 mm	342P006033
21	Tip holder M6 / L=29 mm	342P006133

Gas diffusers

► 30	Gas diffuser, black	130P002026
30	Gas diffuser, white	130P002017
30	Gas diffuser, ceramic	130P002019
30	Gas diffuser, brown	130P002031

Gas nozzles

► 40	Nozzle conical. diam. 16 mm	345P022171
41	Nozzle cylindrical diam. 19 mm	345P021171

Spare parts

50	Inner tube TBi 7W E3	274P101013
51	Outer tube TBi 360/511/7G/7W E3	234P102035
52	Fume shroud TBi 360/511/7G/7W/8W E3	200P002043
53	Insulating washer	130P002004
60	Handle cpl., blue, housed micro switch, TBi E2/E3	380P220606
61	Self-cutting screw 3.5x14.0 mm	100P797101
62	Self-cutting screw, short, TBi E3	100P008411

63	Micro switch, housed, cpl.	600P101046
64	Air regulator large	200P102001
65	Fillister head screw, 2.9x6.5 mm	100P797103
66	Handle fitting for 38 mm fume hose	274P102011
70	Fume extraction hose D=38 mm	306P384600
71	T-joint cpl. for 38 mm fume hose	200P101012
72	Water-power cable Top 2000, blue, 2-C	316P1622_0*
73	Water hose 2-C, black, 5x1.5 mm	303P070000
75	PVC-Gas hose, black 4.5x1.5 mm	302P010000
76	Control cable x.10m, round, cpl., for TBi E1/E2/E3	301P2304_1*
77	Wire conduit yellow (Top 2000)	356P0C0C_0*
80	Cable support housing (only with pos. 81)	701P102070
81	Cable support cover (only with pos. 80)	701P102071
82	Adaptor nut	701P001013
83	Central adaptor ESW cpl., moveable pins (Top 2000)	701P101006
84	Sleeve nut M10x1	701P002005
85	O-ring 4.0x1.0 mm (gas nipple)	365P100040
86	Slotted screw M4x6	100P008401
90	Quick connector	701P002064
91	Hose clamp Ø 9.5 with ring	373P100095
92	Hose clamp Ø 8.7	371P000087
94	Insulated connector, male, round	375P000004
95	Insulated connector, female, round	375P000003
96	Rubber hose 10x2.0 mm	310P102102

Wire guides

► 100	Liner w/o insulation (x.40 m) for wire 1.0-1.2	322P2045_4*
100	Liner w/o insulation (x.40 m) for wire 1.4-1.6	322P2545_4*
110	PTFE-liner red (x.50 m) for wire 1.0-1.2	326P2040_5*
110	PTFE-liner yellow (x.50 m) for wire 1.2-1.6	326P2747_5*
111	Collet for liners 4.0 mm	331P020040
111	Collet for liners 4.7 mm	331P027047
113	Support tube 5x4.4 mm, L=150 mm	329P544150
120	PA-Alu wire guide (x.50 m) for wire 1.0-1.2	328P2040_A*
120	PA-Alu wire guide (x.50 m) for wire 1.2-1.6	328P2347_A*

► = Standardausüstung

* Bitte an Leerstelle entsprechende Angaben für Brennerlänge oder Drahtdurchmesser einsetzen, z.B. 08 für 0.8 mm, bzw. 3 für 3 mm.

© 2012 TBi Industries GmbH. All rights reserved. Subject to change without notice. Warranty only when using original TBi consumables and spare parts. Excerpts and reprints not permitted. Nr. DOKP113432, 07/2012.

TBi Industries GmbH
Ruhberg 14
D-35463 Fernwald-Steinbach
P.O. Box 67
D-35461 Fernwald-Steinbach

Tel. + 49 6404 9171-0
Fax. + 49 6404 9171-40
Internet: www.tbi-industries.com
E-mail: info@tbi-industries.com